

GENERAL CHARACTERISTICS

The SCV capacitive probes are the best way to monitor the level condition of liquids as water, oil, gasoline and solid products as powder and granular. The probes are available in different length and the electronic circuit is based on a microprocessor technology which offers an high reliability in the heavy working condition of the industrial applications.

- No moving parts
- PTFE electrode insulation
- Sealed construction, epoxy resin
- IP65 protection class



TECHNICAL DATA Tab.1

Description	Characteristics	
Supply voltage	12 – 35 Vdc	
Supply current	5 mA	
Electrical output NPN max. load 3W	I2	I1
	Active	No-Active
Switch delay	4 sec.	In no level conditions from 1 to 10 sec. on request
Differential	3 mm.	T from 0 to 5 mm. on request
Electrode	Cu-Zn alloy	
Electrode coating	E	PTFE
Switch point L1	Mounting position	
	Vertical L0 - 10 ± 2 mm.	Horizontal: on the axis of the probe
Length L0 mm.	50 90	max. 1000 on request
Electrical connection	S1	Plug DIN 43650
	S3	M12x1, 4 poles
Pressure Bar max.	25	
Temperature °C max.	-30 / +125	
Application – Liquid type	W	H ₂ O and conductive liquids
	Z	OIL and no-conductive liquids

DIMENSIONS and MATERIALS Tab.2

DN	F Connection	SW mm	B mm	A mm	A1 mm
008	1/4"	24	10	74	58
015	1/2"	24	14	74	58

Male threads

N	G	C
NPT Conical	Gas parallel UNI 228/1	Gas conical UNI 7/1
On request		

Materials

O	S
Brass	AISI-316
On request	

NOMENCLATURE

SCV	W	008	NO	E50	I2	T	S1
•							
	•						
		•					
			•				
				•			
					•		
						•	
							•

WIRING

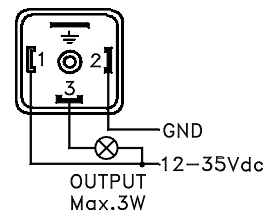

S1

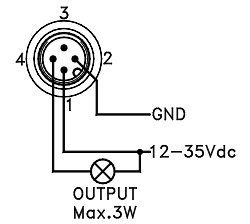

S3

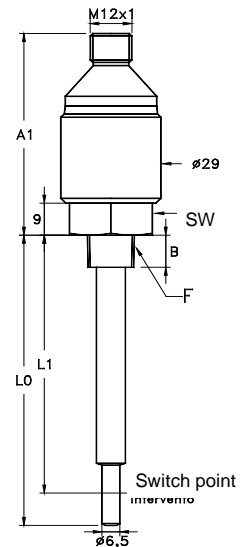
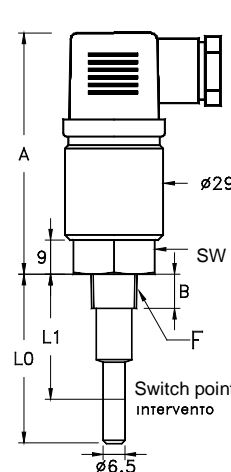

MAINTENANCE

Periodically check the electrode and coating conditions, if needed provide to clean the parts avoiding to use corrosive products.